

AIR DEVICE S55 • Installation

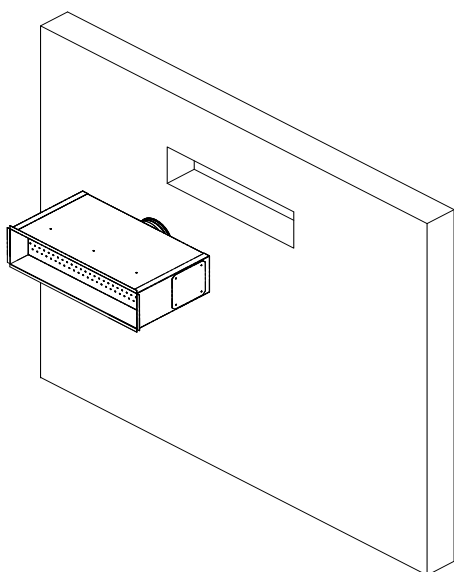

Install the box to the wall.

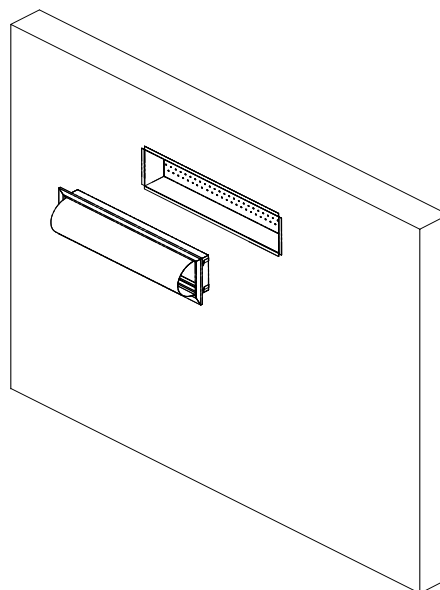

Push the grille to the box.

Nb!

The air direction is marked with an arrow on the side of the grille.
The arrow should be down!

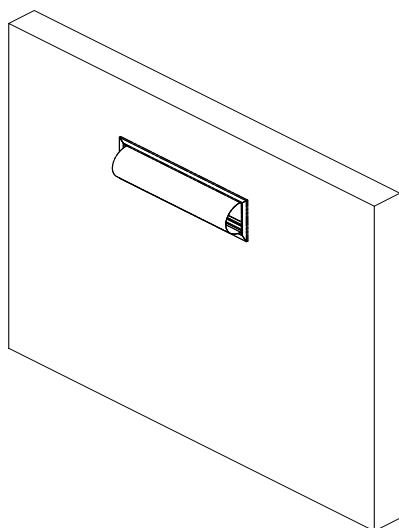

FINISHED!

Minimum distances:

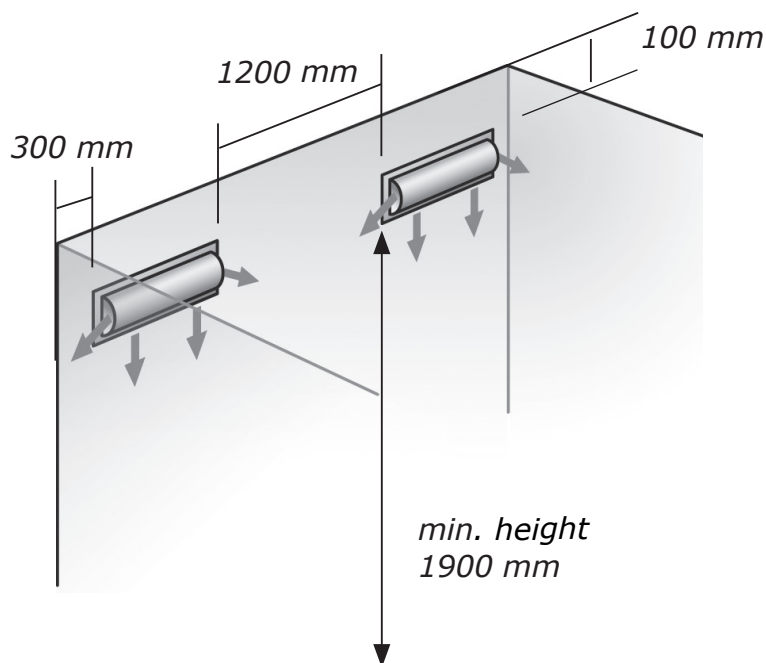

Minimum distance between two S55 devices is 1200mm.
Minimum distance from a wall is 300mm and from ceiling 100mm

Dimensions

Size	H	B	D	C	F	G	ød
400 x 110 mm	115	400	260	40	146	430	100
500 x 135 mm	140	500	285	40	170	530	125
600 x 170 mm	175	600	320	40	200	630	160

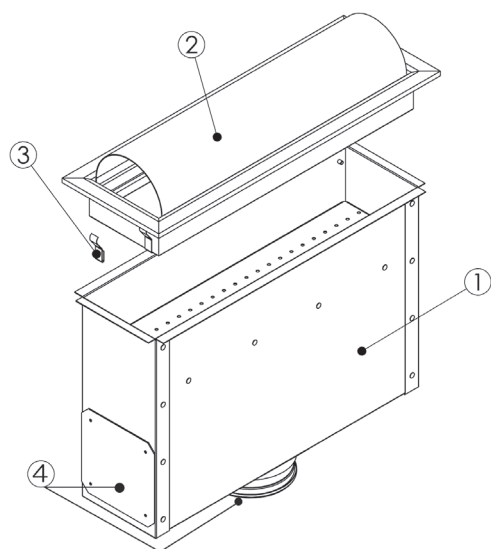
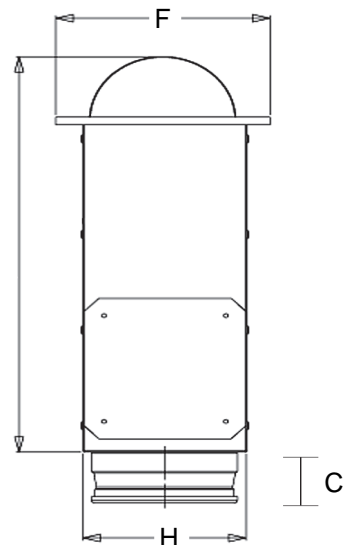
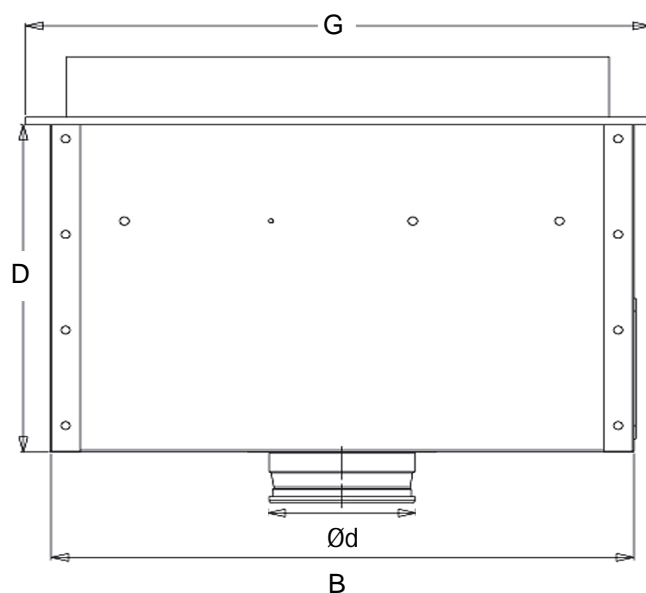

1. Supply box
2. Grille and frame
3. Fastening clips
4. Alternative air supply (can be changed at workplace)

Air device	Amount of nozzles (all open)	Max air volume with different pressures (Pa), dm ³ /s					
		60 Pa	70 Pa	80 Pa	90 Pa	100 Pa	120 Pa
S55-100	92	21 l/s	23 l/s	25 l/s	26 l/s	28 l/s	30 l/s
S55-125	135	31 l/s	34 l/s	36 l/s	38 l/s	41 l/s	44 l/s
S55-160	231	54 l/s	58 l/s	62 l/s	66 l/s	69 l/s	76 l/s

Operation and maintenance

Description

The S55 is an square-shaped air device for wall installation. The device can be delivered with air supply connection from the side or back. The S55 is suitable for isothermal and cold air.

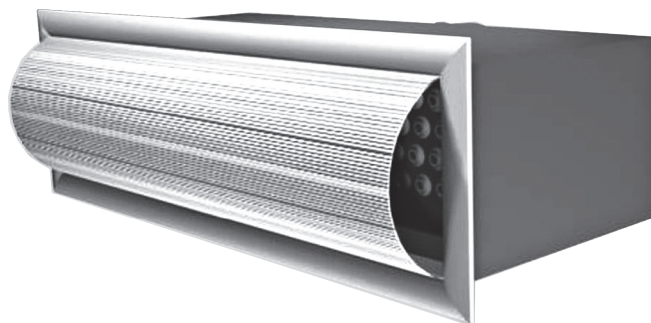

Maintenance / cleaning

The grille is cleaned with an wt rag or a vacuum cleaner. If necesseary use a mild cleaner (don't use solvents).

Balancing

The S55 is delivered adjusted to an desired airflow with an certain pressure. The pressure, airflow and amount of open nozzles is mentioned on the sticker on the box.

When making control measurements in the building measure the air-pressure from the nozzle (Pa)

$$q = A \cdot k \cdot \sqrt{P}$$

q = air volume (l/s)

A = open nozzles

k = nozzle k-factor (0,03)

P = pressure (Pa), measured from the nozzle



STRAVENT OY
Olarinluoma 7
FI-02200 Espoo Finland

Contact
Tel. +358 9-424 13630
Fax. +358 9-424 13631

www.stravent.fi